

WBS NO: 2026CPT.01.16.10581, ETC.

CONTRACT: DA00667

**STATE OF NORTH CAROLINA
DIVISION OF HIGHWAYS**

MARTIN

STATE	STATE PROJECT REFERENCE NUMBER	SHEET NO.
NC	2026CPT.01.16.10581, ETC.	1
STATE PROJECT NUMBER		DESCRIPTION
2026CPT.01.16.10581		P.E., CONST.
2026CPT.01.16.20581		P.E., CONST.

TYPE OF WORK: MILLING & RESURFACING

MAP	ROUTE	FROM	TO
01	US 17 Bus. (Washington St.)	US 64 Alt. (West/East Blvd.)	US 17 Bus. (S. Elm St.)
02	US 17 Bus. (S. Haughton St.)	US 17 Bus. (S. Elm St.)	NC 125 (N. Haughton St.)
03	US 17 Bus. (W. Main St.)	NC 125 (N. Haughton St.)	End of C&G
04	US 17 Bus. (E. Main S)	End of C&G	US 13 (East Boulevard)
05	US 17 Bus. (S. Elm St.)	NC 125 (N. Haughton St.)	US 17 Bus. (Washington St.)
06	US 17 Bus. (S. Elm St.)	NC 125 (N. Haughton St.)	US 17 Bus. (Washington St.)
07	NC 125	US 17 Bus. (W. Main St.)	End of 3 Lane
08	NC 125	End of 3 Lane	NC 125 Bypass
09	SR 1446 (Jamesville Rd.)	US 17 Bus.	US 64 Alt. West
10	SR 1450 (River Rd.)	US 17 Bus.	MP 0.34
11	SR 1450 (River Rd.)	MP 0.34	US 17 Bus.

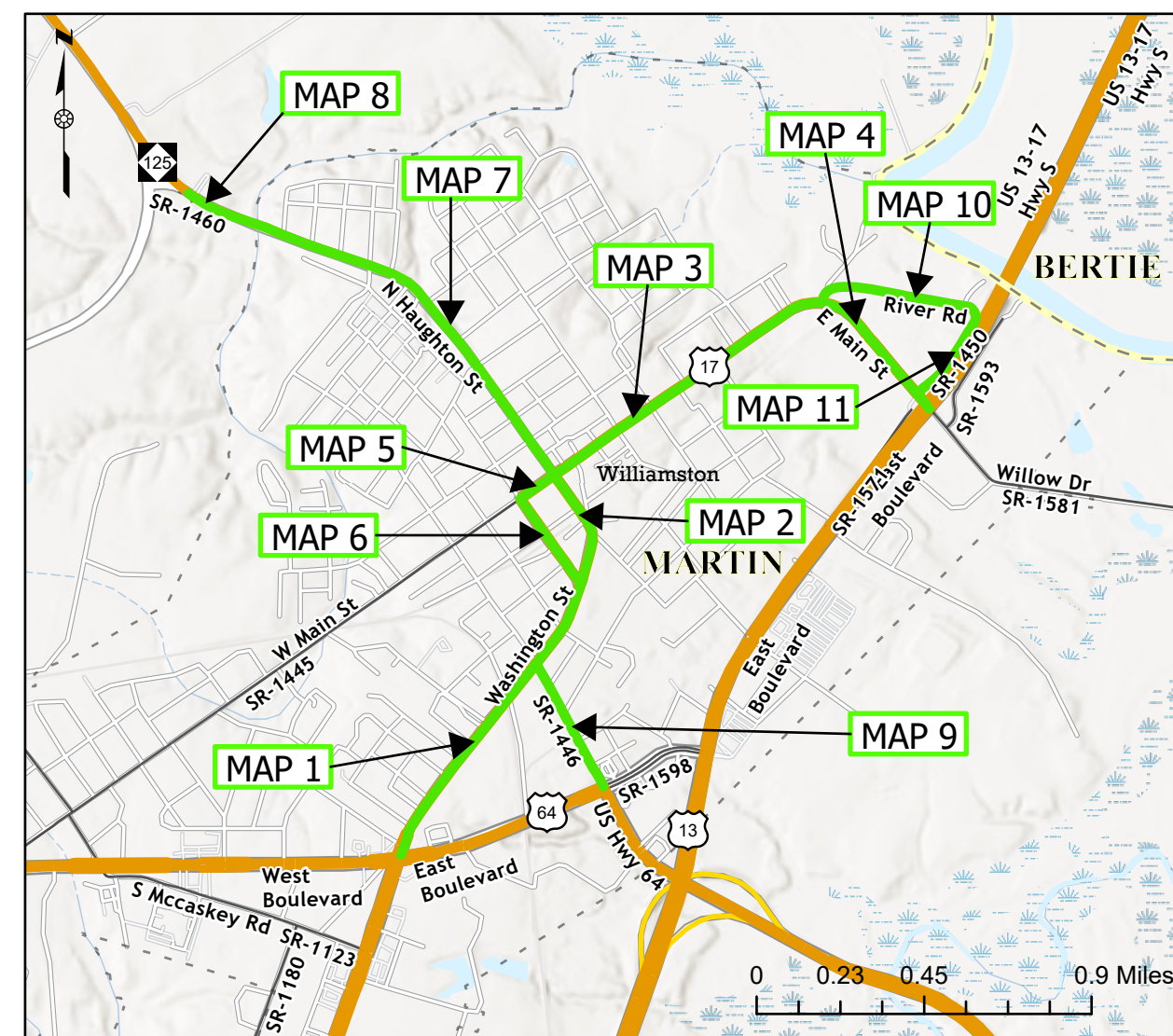

PROJECT LENGTH

MAP	MILES	MAP	MILES	MAP	MILES
01	0.703	05	0.087	09	0.305
02	0.274	06	0.220	10	0.34
03	0.647	07	0.894	11	0.24
04	0.360	08	0.175		

Prepared in the Office of:
DIVISION OF HIGHWAYS
113 AIRPORT DR., EDENTON, NC 27932

B. N. BRASWELL, PE
DIV. PROJ. DEVELOPMENT ENGINEER

M. S. WINSLOW
DIVISION CONTRACT ENGINEER

D. J. CLODGO, PE, PMP
DIVISION PROJECT TEAM LEAD

D. H. STALLINGS
DIVISION DESIGN ENGINEER



PAVEMENT SCHEDULE

C1	PROP. APPROX. 1.5" ASPHALT CONCRETE SURFACE COURSE, TYPE S9.5C, AT AN AVERAGE RATE OF 168 LBS. PER SQ. YD.
V1	INCIDENTAL MILLING
V2	MILLING ASPHALT PAVEMENT, 1.5" DEPTH
U	EXISTING PAVEMENT

NOTES:

- * ALL INTERSECTING ROADS ARE TO BE RESURFACED TO THE ENDS OF THEIR RADII, THE MAIN LINE RIGHT OF WAY OR AS DIRECTED BY THE ENGINEER. THIS SHALL INCLUDE ANY TAPERS AND TURN LANES LOCATED BOTH ON THE MAIN LINE OR INTERSECTING PAVED ROADWAY.
- * EDGES, PAVEMENT WIDENING, INTERSECTIONS AND BRIDGE FLARES ARE INCLUDED IN THE SUMMARY OF QUANTITIES.
- * 1.5" OF S9.5C TO BE APPLIED THE FULL WIDTH OF THE ROADWAY
- * CONTRACTOR SHALL PERFORM PATCHING EXISTING PAVEMENT ON MAPS 2,5,6,7,& 9 FULL DEPTH BEFORE APPLICATION OF 1.5" OF S9.5C
- * INCIDENTAL MILLING SHALL BE PERFORMED ON ALL MAPS EXCEPT FOR MAP #8
- * **USE OF A MATERIAL TRANSFER VEHICLE IS REQUIRED FOR MAPS 1 - 8**

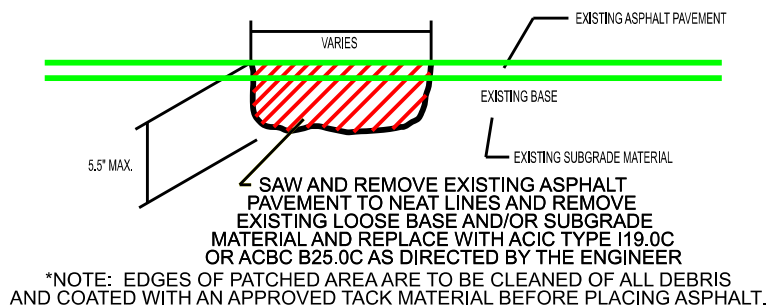

*NOTE: EDGES OF PATCHED AREA ARE TO BE CLEANED OF ALL DEBRIS AND COATED WITH AN APPROVED TACK MATERIAL BEFORE PLACING ASPHALT.

PATCHING EXISTING PAVEMENT (FULL DEPTH)

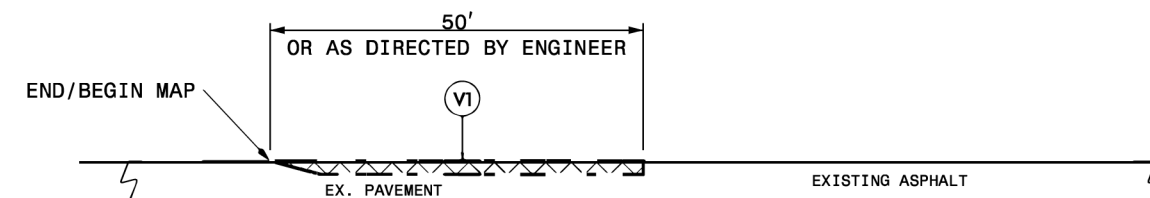

DETAIL 1

MAIN LINE MILLING

- NOTE:
1. INCLUDES INCIDENTAL MILLING AT THE ENDS OF MAIN LINE SECTIONS, OR AS DIRECTED BY THE ENGINEER.
 2. PAVE TO THE END OF THE MILLED SURFACE TO CREATE A SMOOTH TRANSITION.

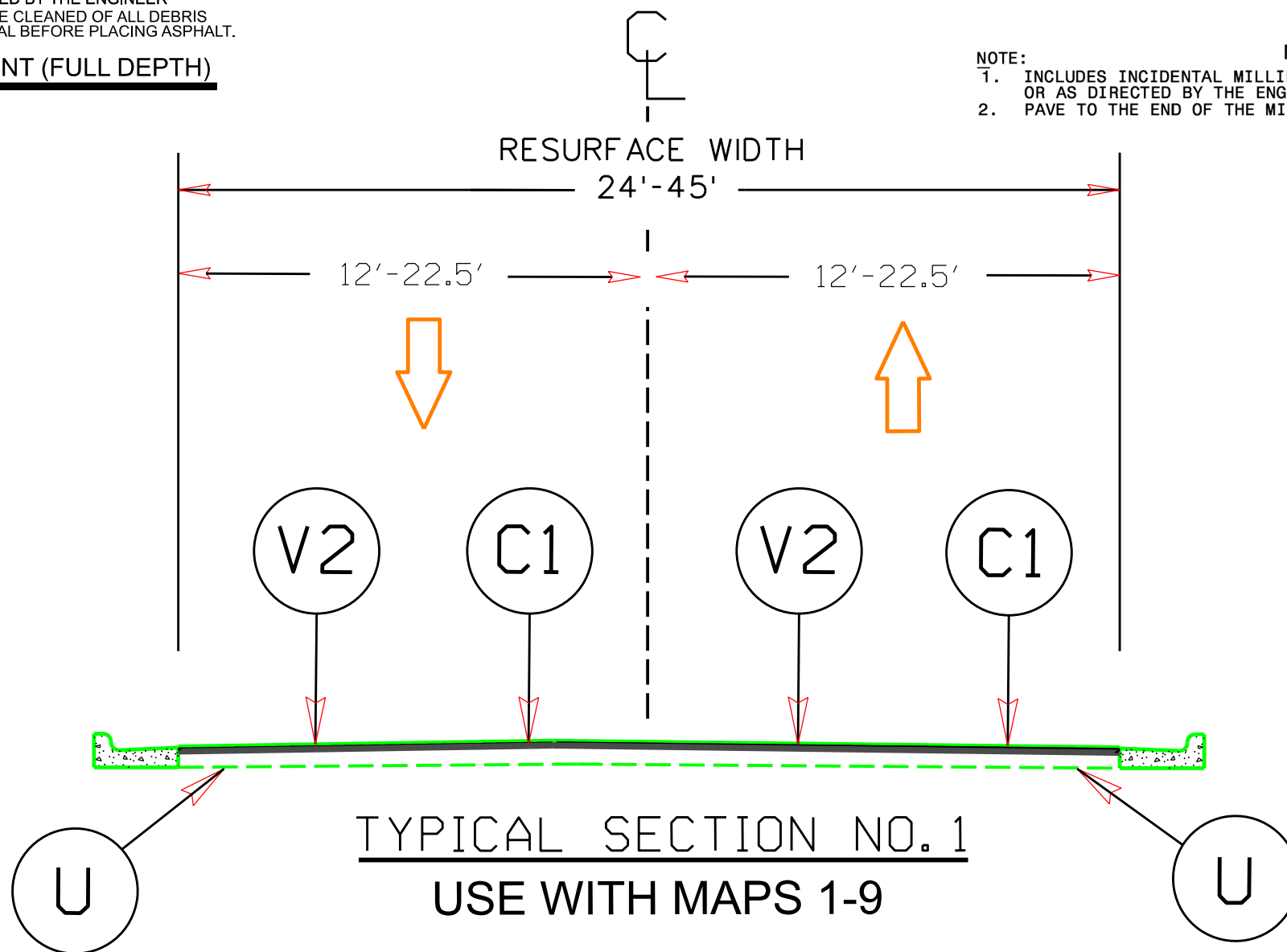

PAVEMENT SCHEDULE

C1	PROP. APPROX. 1.5" ASPHALT CONCRETE SURFACE COURSE, TYPE S9.5B, AT AN AVERAGE RATE OF 168 LBS. PER SQ. YD.
U	EXISTING PAVEMENT
T	SHOULDER RECONSTRUCTION

PROJECT REFERENCE NO.	SHEET NO.
2026CPT.01.16.10581, ETC.	3

NOTES:

- * ALL INTERSECTING ROADS ARE TO BE RESURFACED TO THE ENDS OF THEIR RADII, THE MAIN LINE RIGHT OF WAY OR AS DIRECTED BY THE ENGINEER. THIS SHALL INCLUDE ANY TAPERS AND TURN LANES LOCATED BOTH ON THE MAIN LINE OR INTERSECTING PAVED ROADWAY.
- * EDGES, PAVEMENT WIDENING, INTERSECTIONS AND BRIDGE FLARES ARE INCLUDED IN THE SUMMARY OF QUANTITIES.
- * 1.5" OF S9.5B TO BE APPLIED THE FULL WIDTH OF THE ROADWAY
- * SHOULDER WEDGE SHALL BE USED ON ALL ROADS 22' OR WIDER OR AS DIRECTED BY THE ENGINEER

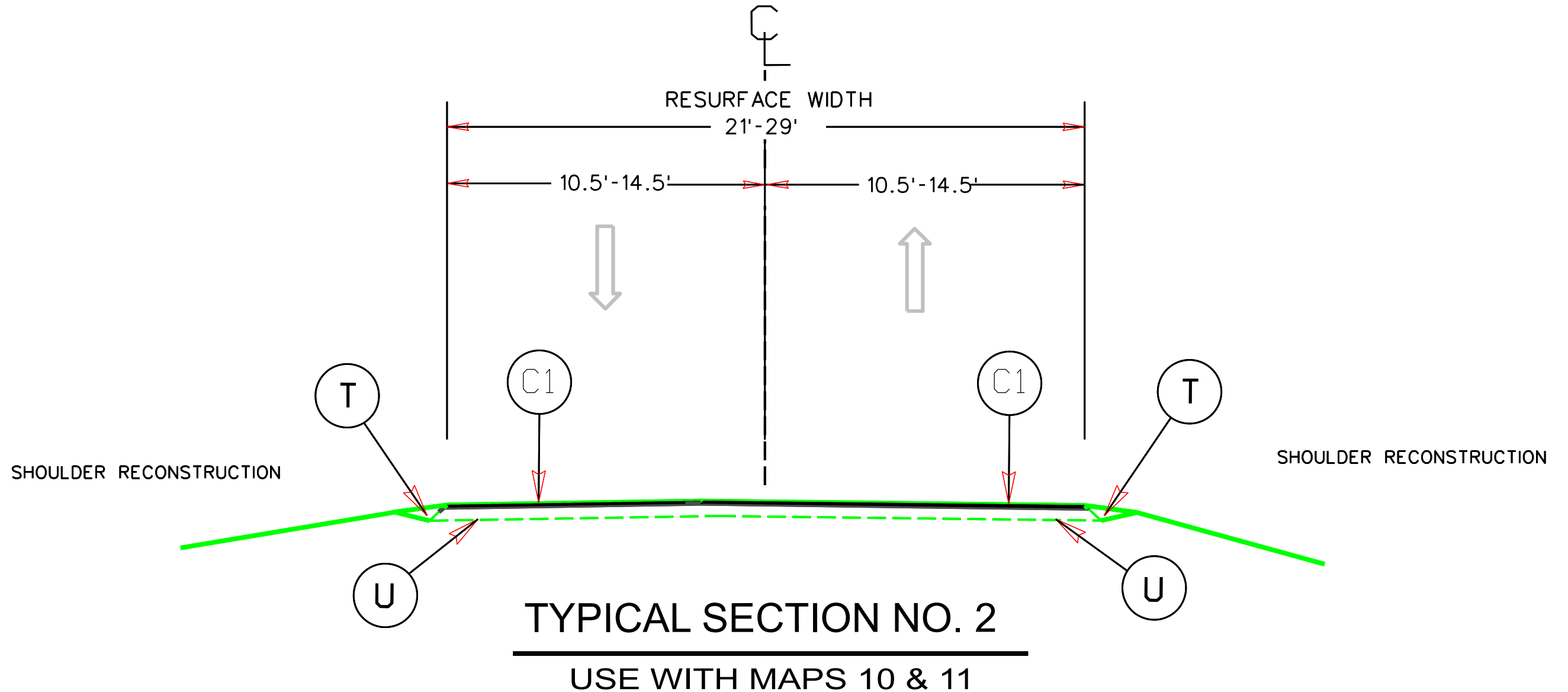

TYPICAL SECTION NO. 2

USE WITH MAPS 10 & 11

SYSTEMS DESIGN

NTS

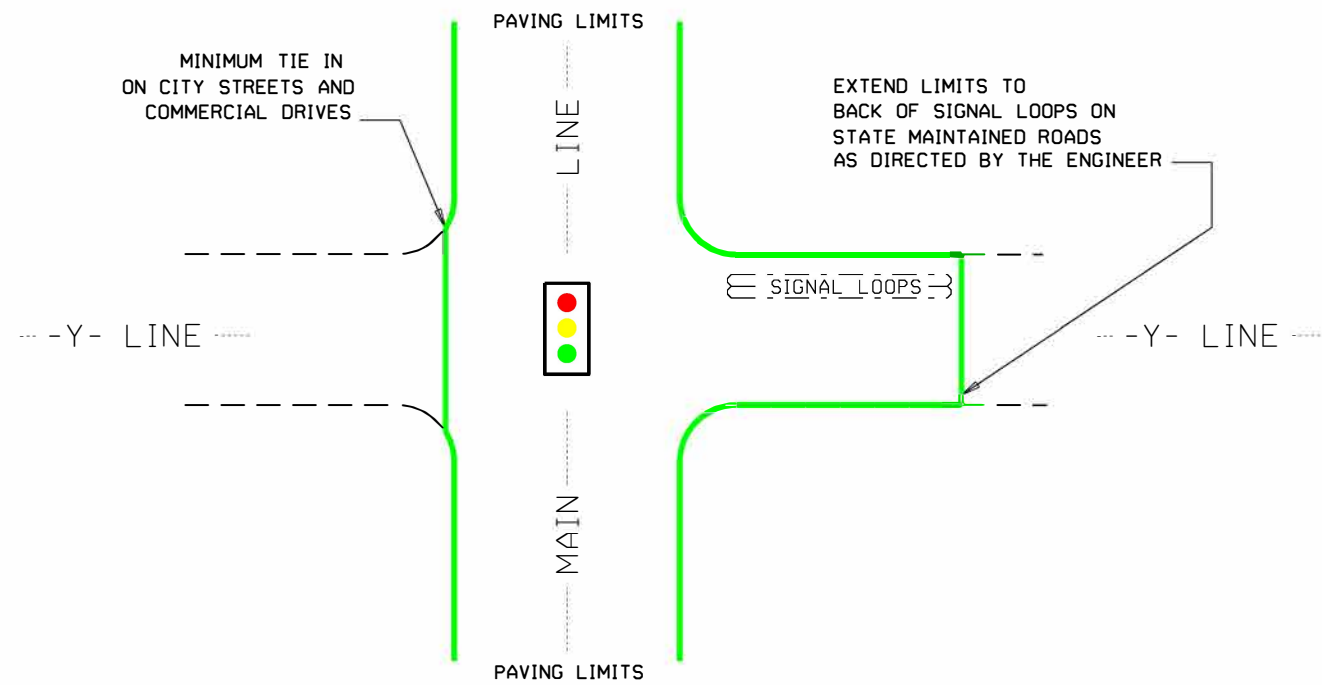

TYPICAL DETAIL OF PROJECT LIMITS AT SIGNALIZED Y LINES

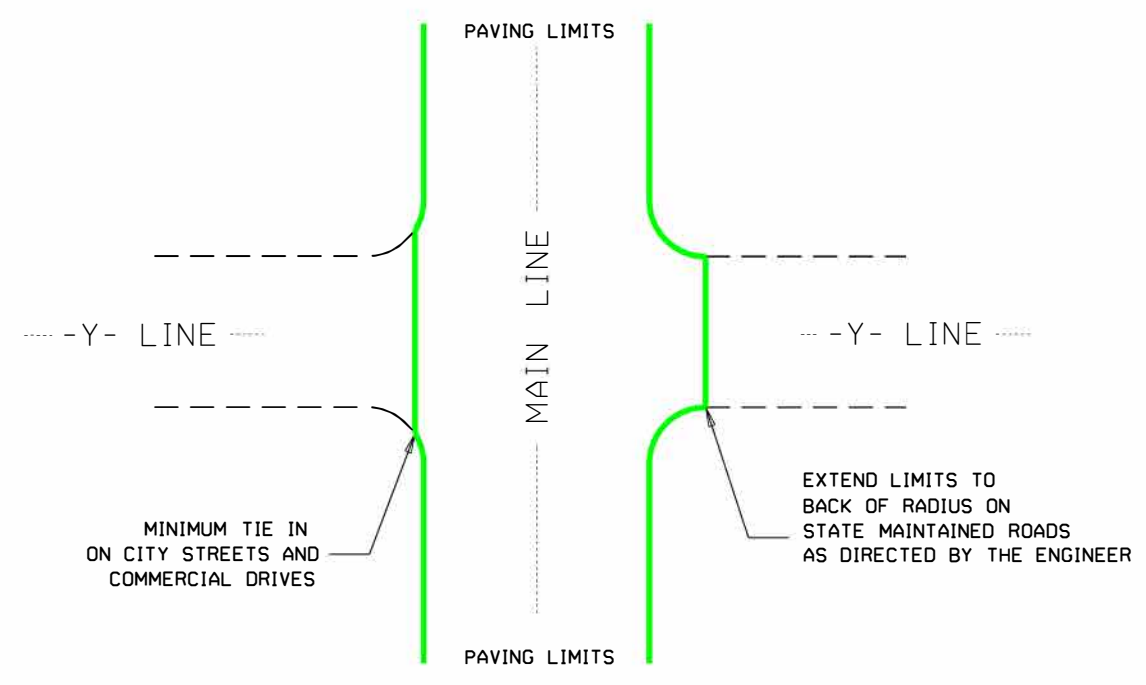

TYPICAL DETAIL OF PROJECT LIMITS AT UNSIGNALIZED Y LINES

ADDITIONAL INTERSECTIONS (NON-TYPICAL)

Extend paving limits to back of radius
or loop on the following intersections:

MAP#	STREET NAME	COMMENTS
	PAVE ALL STATE OWNED & TOWN STREETS TO BACK OF RADIUS FOR THIS PROJECT	

PROJECT NO.	SHEET NO.	TOTAL NO.
2026CPT.01.16.10581, ETC.	5	

SUMMARY OF QUANTITIES

PROJECT NO	COUNTY	MAP NO	ROUTE	DESCRIPTION	TYP NO	LANES	LANE TYPE	LENGTH	WIDTH	BEG N MP	END MP	0000100000-N	0106000000-E	1220000000-E	1245000000-E	1297000000-E	1330000000-E	1523000000-E	
												MOBILIZATION	BORROW EXCAVATION	INCIDENTAL STONE BASE	SHOULDER RECONSTRUCTION	MILLING ASPHALT PAVEMENT, **** DEPTH (1-1/2")	INCIDENTAL MILLING	ASP CONC SURF CRS S9.5C	
												LS	CY	TONS	SMI	SY	SY	TONS	
2026CPT.01.16.10581	Martin	1	US-17 BUS N / WASHINGTON ST	FROM US 64 ALT. (WEST/EAST BLVD.) TO US 17 BUS. (S. ELM ST.)	1	2	MU	0.703	44	1.616	2.319	1					18,147	903	1,620
2026CPT.01.16.10581	Martin	2	US-17 BUS N / WASHINGTON ST/S HAUGHTON ST	FROM US 17 BUS. (S. ELM ST.) TO NC 125 (N. HAUGHTON ST.)	1	2	MU	0.274	38	2.319	2.593	*					6,108	308	559
2026CPT.01.16.10581	Martin	3	US-17 BUS N / S HAUGHTON ST/W MAIN ST/E MAIN ST	FROM NC 125 (N. HAUGHTON ST.) TO END OF C&G	1	2	M2	0.647	1	2.593	3.240	*					16,006	548	1,460
2026CPT.01.16.10581	Martin	4	US-17 BUS N / E MAIN ST/WILLOW DR	FROM END OF C&G TO US 13 (EAST BOULEVARD)	1	2	2WU	0.360	24	3.240	3.600	*					5,463	361	487
2026CPT.01.16.10581	Martin	5	US-17 BUS S / W MAIN ST	FROM NC 125 (N. HAUGHTON ST.) TO US 17 BUS. (S. ELM ST.)	1	2	MU	0.087	46	1.033	1.120	*					2,348	122	218
2026CPT.01.16.10581	Martin	6	US-17 BUS S / S ELM ST	FROM NC 125 (N. HAUGHTON ST TO US 17 BUS. (WASHINGTON ST.)	1	2	2WU	0.220	35	1.130	1.350	*					4,517	127	411
2026CPT.01.16.10581	Martin	7	NC-125 N / NC 125	FROM US 17 BUS. (W. MAIN ST.) TO END OF 3 LANE	1	2	2WU	0.894	35	4.356	5.250	*					18,357	951	7,398
2026CPT.01.16.10581	Martin	8	NC-125 N / NC 125	FROM END OF 3 LANE TO NC 125 BYPASS	1	2	2WU	0.175	23	5.250	5.425	*					3,508		209
TOTAL FOR PROJ NO. 2026CPT.01.16.10581								3.360				*					74,454	3,320	12,362
2026CPT.01.16.20581	Martin	9	SR-1446 / JAMESVILLE RD	FROM US 17 BUS. TO US 64 ALT. WEST	1	2	2WU	0.305	40	0.000	0.305	*					7,157	591	677
2026CPT.01.16.20581	Martin	10	SR-1450 / RIVER RD	FROM US 17 BUS. TO MP 0.34	2	2	2WU	0.340	29	0.000	0.340	*	61	9	0.68				540
2026CPT.01.16.20581	Martin	11	SR-1450 / RIVER RD	FROM MP 0.34 TO US 17 BUS.	2	2	2WU	0.240	21.5	0.340	0.580	*	43	1	0.48				269
TOTAL FOR PROJ NO. 2026CPT.01.16.20581								0.885				*	104	10	1.16		7,157	591	1,486
GRAND TOTAL								4.245				1	104	10	1.16		81,611	3,911	13,848

SUMMARY OF QUANTITIES

PROJECT NO	COUNTY	MAP NO	ROUTE	DESCRIPTION	TYP NO	LANES	LANE TYPE	LENGTH	WIDTH	BEG N MP	END MP	1524000000-E	1575000000-E	1705000000-E	2830000000-N	2845000000-N	6084000000-E	6117000000-N	
												ASP CONC SURF CRS S9.5C LEVEL	ASP FOR PLANT MIX	PATCHING EXISTING PAVEMENT (FULL DEPTH)	ADJ MANHOLES	ADJ METER OR VALVE BOXES	SEEDING & MULCHING	RESPONSE FOR EROSION CONTROL	
												TONS	TONS	TONS	EA	EA	ACR	EA	
2026CPT.01.16.10581	Martin	1	US-17 BUS N / WASHINGTON ST	FROM US 64 ALT. (WEST/EAST BLVD.) TO US 17 BUS. (S. ELM ST.)	1	2	MU	0.703	44	1.616	2.319	53	99						
2026CPT.01.16.10581	Martin	2	US-17 BUS N / WASHINGTON ST/S HAUGHTON ST	FROM US 17 BUS. (S. ELM ST.) TO NC 125 (N. HAUGHTON ST.)	1	2	MU	0.274	38	2.319	2.593		33	10	2	2			
2026CPT.01.16.10581	Martin	3	US-17 BUS N / S HAUGHTON ST/W MAIN ST/E MAIN ST	FROM NC 125 (N. HAUGHTON ST.) TO END OF C&G	1	2	M2	0.647	1	2.593	3.240		86		3	3			
2026CPT.01.16.10581	Martin	4	US-17 BUS N / E MAIN ST/WILLOW DR	FROM END OF C&G TO US 13 (EAST BOULEVARD)	1	2	2WU	0.360	24	3.240	3.600		29		1				
2026CPT.01.16.10581	Martin	5	US-17 BUS S / W MAIN ST	FROM NC 125 (N. HAUGHTON ST.) TO US 17 BUS. (S. ELM ST.)	1	2	MU	0.087	46	1.033	1.120		13	5	3				
2026CPT.01.16.10581	Martin	6	US-17 BUS S / S ELM ST	FROM NC 125 (N. HAUGHTON ST TO US 17 BUS. (WASHINGTON ST.)	1	2	2WU	0.220	35	1.130	1.350		25	5					
2026CPT.01.16.10581	Martin	7	NC-125 N / NC 125	FROM US 17 BUS. (W. MAIN ST.) TO END OF 3 LANE	1	2	2WU	0.894	35	4.356	5.250		437	3					
2026CPT.01.16.10581	Martin	8	NC-125 N / NC 125	FROM END OF 3 LANE TO NC 125 BYPASS	1	2	2WU	0.175	23	5.250	5.425		12						
TOTAL FOR PROJ NO. 2026CPT.01.16.10581								3.360				53	734	23	9	5			
2026CPT.01.16.20581	Martin	9	SR-1446 / JAMESVILLE RD	FROM US 17 BUS. TO US 64 ALT. WEST	1	2	2WU	0.305	40	0.000	0.305		40	5		3			
2026CPT.01.16.20581	Martin	10	SR-1450 / RIVER RD	FROM US 17 BUS. TO MP 0.34	2	2	2WU	0.340	29	0.000	0.340		32			1	0.3	1	
2026CPT.01.16.20581	Martin	11	SR-1450 / RIVER RD	FROM MP 0.34 TO US 17 BUS.	2	2	2WU	0.240	21.5	0.340	0.580		16			0.2			
TOTAL FOR PROJ NO. 2026CPT.01.16.20581								0.885				88	5		4	0.6	1		
GRAND TOTAL								4.245				53	822	28	9	9	0.6	1	

PROJECT NO.	SHEET NO.	TOTAL NO.
2026CPT.01.16.10581, ETC.	6	

THERMOPLASTIC AND PAINT QUANTITIES

PROJECT NO	COUNTY	MAP NO	ROUTE	DESCRIPTION	TYP NO	LANES	LANE TYPE	LENGTH	WIDTH	BEGIN MP	END MP	4413000000-E	4457000000-N	4685000000-E		4688000000-E		4695000000-E	4700000000-E	4709000000-E		4720000000-E			4725000000-E					
												WORK ZONE ADVANCE/GENERAL WARNING SIGNING	TEMPORARY TRAFFIC CONTROL (SP)	THERMOPLASTIC PAVEMENT MARKING LINES (4", 90 MILS) WHITE	THERMOPLASTIC PAVEMENT MARKING LINES (4", 90 MILS) YELLOW	THERMOPLASTIC PAVEMENT MARKING LINES (6", 90 MILS) WHITE	THERMOPLASTIC PAVEMENT MARKING LINES (6", 90 MILS) YELLOW	THERMOPLASTIC PAVEMENT MARKING LINES (8", 90 MILS) WHITE	THERMOPLASTIC PAVEMENT MARKING LINES (12", 90 MILS)	THERMO PAVEMENT MARKING LINES (24" 90 MILS) (SP)	THERMOPLASTIC PAVEMENT MARKING LINES (24" 90 MILS)	THERMOPLASTIC PAVEMENT MARKING CHARACTER (90 MILS), SCHOOL	THERMOPLASTIC PAVEMENT MARKING CHARACTER (90 MILS), RXR	THERMOPLASTIC PAVEMENT MARKING CHARACTER (90 MILS), XING	THERMOPLASTIC PAVEMENT MARKING SYMBOL (90 MILS), STR ARROW	THERMOPLASTIC PAVEMENT MARKING SYMBOL (90 MILS), LT ARROW	THERMOPLASTIC PAVEMENT MARKING SYMBOL (90 MILS), RT ARROW	THERMOPLASTIC PAVEMENT MARKING SYMBOL (90 MILS), STR & RT ARROW	THERMOPLASTIC PAVEMENT MARKING SYMBOL (90 MILS), STR & LT ARROW	THERMOPLASTIC PAVEMENT MARKING SYMBOL (90 MILS), BICYCLE
												SF	LS	LF	LF	LF	LF	LF	LF	LF	LF	EA	EA	EA	EA	EA	EA	EA	EA	
2026CPT.01.16.10581	Martin	1	US-17 BUS N / WASHINGTON ST	FROM US 64 ALT. (WEST/EAST BLVD.) TO US 17 BUS. (S. ELM ST.)	1	2	MU	0.703	44	1.616	2.319	110	1			7,661	4,640			280		2	4		2	1	1	5	3	
2026CPT.01.16.10581	Martin	2	US-17 BUS N / WASHINGTON ST/S HAUGHTON ST	FROM US 17 BUS. (S. ELM ST.) TO NC 125 (N. HAUGHTON ST.)	1	2	MU	0.274	38	2.319	2.593	51	*			362				47					2		2			
2026CPT.01.16.10581	Martin	3	US-17 BUS N / S HAUGHTON ST/W MAIN ST/E MAIN ST	FROM NC 125 (N. HAUGHTON ST.) TO END OF C&G	1	2	M2	0.647	1	2.593	3.24	86	*	716		8,970	6,832	80	104			213			2		8		10	
2026CPT.01.16.10581	Martin	4	US-17 BUS N / E MAIN ST/WILLOW DR	FROM END OF C&G TO US 13 (EAST BOULEVARD)	1	2	2WU	0.36	24	3.24	3.6	86	*			3,802	3,802						2							2
2026CPT.01.16.10581	Martin	5	US-17 BUS S / W MAIN ST	FROM NC 125 (N. HAUGHTON ST.) TO US 17 BUS. (S. ELM ST.)	1	2	MU	0.087	46	1.033	1.12	54	*			230	574			54					2		4		2	
2026CPT.01.16.10581	Martin	6	US-17 BUS S / S ELM ST	FROM NC 125 (N. HAUGHTON ST.) TO US 17 BUS. (WASHINGTON ST.)	1	2	2WU	0.22	35	1.13	1.35	54	*			290														
2026CPT.01.16.10581	Martin	7	NC-125 N / NC 125	FROM US 17 BUS. (W. MAIN ST.) TO END OF 3 LANE	1	2	2WU	0.894	35	4.356	5.25	118	*			520	11,801	68	252			94								28
2026CPT.01.16.10581	Martin	8	NC-125 N / NC 125	FROM END OF 3 LANE TO NC 125 BYPASS	1	2	2WU	0.175	23	5.25	5.425	43	*			1,848	1,155													
TOTAL FOR PROJ NO. 2026CPT.01.16.10581												602	*	716		23,683	28,804	148	356	381	307	2	4	2	6	43	1	19	3	2
														716		52,487				688		8				74				
2026CPT.01.16.20581	Martin	9	SR-1446 / JAMESVILLE RD	FROM US 17 BUS. TO US 64 ALT. WEST	1	2	2WU	0.305	40	0	0.305	86	*			485	2,013			25					1	2		2		
2026CPT.01.16.20581	Martin	10	SR-1450 / RIVER RD	FROM US 17 BUS. TO MP 0.34	2	2	2WU	0.34	29	0	0.34		*			3,590	3,590													
2026CPT.01.16.20581	Martin	11	SR-1450 / RIVER RD	FROM MP 0.34 TO US 17 BUS.	2	2	2WU	0.24	21.5	0.34	0.58		*			2,534	2,534													
TOTAL FOR PROJ NO. 2026CPT.01.16.20581												86	*	6,609	8,137					25				1	2		2			
														14,746						25					5					
GRAND TOTAL													1	7,325	8,137	23,683	28,804	148	356	406	307	2	4	2	7	45	1	21	3	2
														15,462		52,487				713		8		79						

PROJECT NO.	SHEET NO.	TOTAL NO.
2026CPT.01.16.10581, ETC.	7	

THERMOPLASTIC AND PAINT QUANTITIES CONTINUED

PROJECT NO	COUNTY	MAP NO	ROUTE	DESCRIPTION	TYP NO	LANES	LANE TYPE	LENGTH	WIDTH	BEGIN MP	END MP	4810000000-E		4815000000-E		4820000000-E		4825000000-E		4830000000-E		4835000000-E		4840000000-N					4845000000-N		4704000000-E		4895000000-N	
												PAINT PAVEMENT MARKING LINES (4") YELLOW	PAINT PAVEMENT MARKING LINES (4") WHITE	PAINT PAVEMENT MARKING LINES (6") WHITE	PAINT PAVEMENT MARKING LINES (6") YELLOW	PAINT PAVEMENT MARKING LINES (8") WHITE	PAINT PAVEMENT MARKING LINES (12")	PAINT PAVEMENT MARKING LINES (16")	PAINT PAVEMENT MARKING LINES (24")	PAINT PAVEMENT MARKING CHARACTER (MSG SCHOOL)	PAINT PAVEMENT MARKING CHARACTER (MSG RXXR)	PAINT PAVEMENT MARKING CHARACTER (MSG XING)	PAINT PAVEMENT MARKING SYMBOL (STR ARROW)	PAINT PAVEMENT MARKING SYMBOL (LT ARROW)	PAINT PAVEMENT MARKING SYMBOL (RT ARROW)	PAINT PAVEMENT MARKING SYMBOL (STR & RT ARROW)	PAINT PAVEMENT MARKING SYMBOL (STR & LT ARROW)	PAINT PAVEMENT MARKING SYMBOL (BICYCLE)	THERMOPLASTIC PAVEMENT MARKING LINES (16" 90 MILS)	GENERIC PAVEMENT MARKING ITEM POLYCARBONATE H-SHAPED MARKERS				
								MI	FT			LF	LF	LF	LF	LF	EA	EA	EA	EA	EA	EA	EA	EA	EA	EA	EA	EA	EA	EA	EA			
2026CPT.01.16.10581	Martin	1	US-17 BUS N / WASHINGTON ST	FROM US 64 ALT. (WEST/EAST BLVD.) TO US 17 BUS. (S. ELM ST.)	1	2	MU	0.703	44	1.616	2.319			7,661	4,640			164	280	2	4		2	1	1	5	3		164	46				
2026CPT.01.16.10581	Martin	2	US-17 BUS N / WASHINGTON ST/S HAUGHTON ST	FROM US 17 BUS. (S. ELM ST.) TO NC 125 (N. HAUGHTON ST.)	1	2	MU	0.274	38	2.319	2.593			362					47				2			2				18				
2026CPT.01.16.10581	Martin	3	US-17 BUS N / S HAUGHTON ST/W MAIN ST/E MAIN ST	FROM NC 125 (N. HAUGHTON ST.) TO END OF C&G	1	2	M2	0.647	1	2.593	3.24	716		8,970	6,832	80	104					213		2	8		10			43				
2026CPT.01.16.10581	Martin	4	US-17 BUS N / E MAIN ST/WILLOW DR	FROM END OF C&G TO US 13 (EAST BOULEVARD)	1	2	2WU	0.36	24	3.24	3.6			3,802	3,802									2				2		24				
2026CPT.01.16.10581	Martin	5	US-17 BUS S / W MAIN ST	FROM NC 125 (N. HAUGHTON ST.) TO US 17 BUS. (S.ELM ST.)	1	2	MU	0.087	46	1.033	1.12			230	574							54		2	4		2			6				
2026CPT.01.16.10581	Martin	6	US-17 BUS S / S ELM ST	FROM NC 125 (N. HAUGHTON ST) TO US 17 BUS. (WASHINGTON ST.)	1	2		0.22	35	1.13	1.35			290																15				
2026CPT.01.16.10581	Martin	7	NC-125 N / NC 125	FROM US 17 BUS. (W. MAIN ST.) TO END OF 3 LANE	1	2	2WU	0.894	35	4.356	5.25			520	11,801	68	252					94				28				59				
2026CPT.01.16.10581	Martin	8	NC-125 N / NC 125	FROM END OF 3 LANE TO NC 125 BYPASS	1	2	2WU	0.175	23	5.25	5.425			1,848	1,155															12				
TOTAL FOR PROJ NO. 2026CPT.01.16.10581												716		23,863	52,487	28,804	148	356	164	688	2	4	2	6	43	1	19	3	2	164	223			
												716		52,487								8			74									
2026CPT.01.16.20581	Martin	9	SR-1446 / JAMESVILLE RD	FROM US 17 BUS. TO US 64 ALT. WEST	1	2	2WU	0.305	40	0	0.305	2,013	485								25			1	2		2							
2026CPT.01.16.20581	Martin	10	SR-1450 / RIVER RD	FROM US 17 BUS. TO MP 0.34	2	2	2WU	0.34	29	0	0.34	3,590	3,590																					
2026CPT.01.16.20581	Martin	11	SR-1450 / RIVER RD	FROM MP 0.34 TO US 17 BUS.	2	2		0.24	21.5	0.34	0.58			2,534	2,534																			
TOTAL FOR PROJ NO. 2026CPT.01.16.20581												8,853	6,609	23,683	28,804	148	356	164	713	2	4	2	7	45	1	21	3	2	164	223				
												8,853	6,609	23,683	28,804	148	356	164	713	2	4	2	7	45	1	21	3	2	164	223				
GRAND TOTAL												15,462		52,487							8			79										

NOTES: Less than 5' - 10' undisturbed buffer from ROW, ditchline, water feature, or drainage inlet, add BMP.

BMP Options: Wattle or Silt Fence

EROSION CONTROL DETAIL

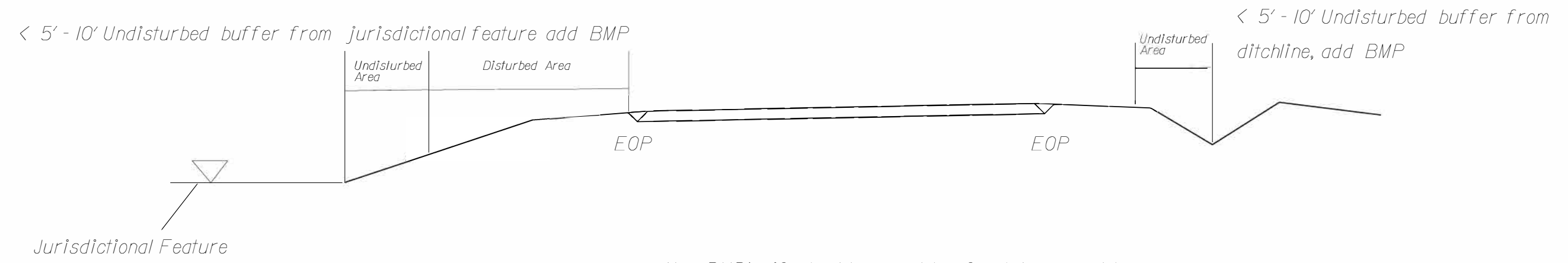
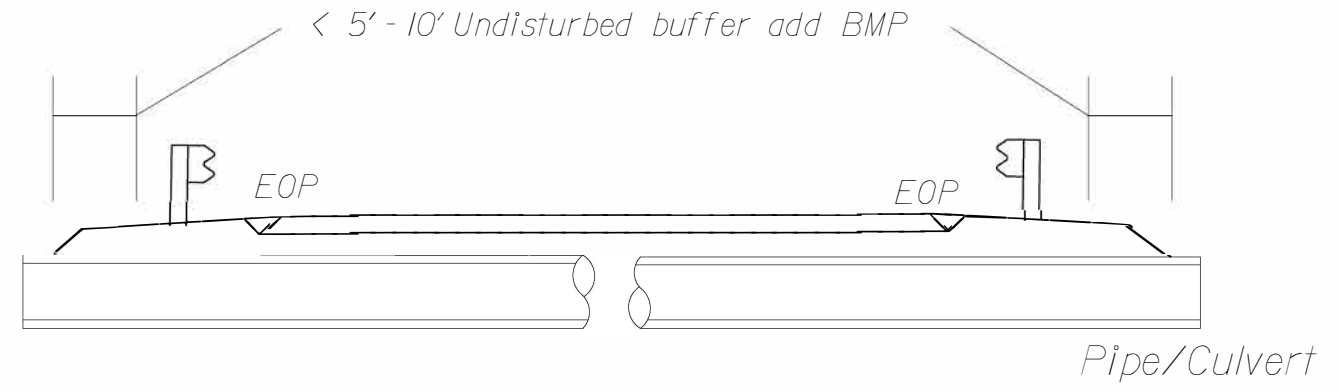

Use BMP's if shoulders and/or frontslopes and/or ditchline and/or backslopes are disturbed

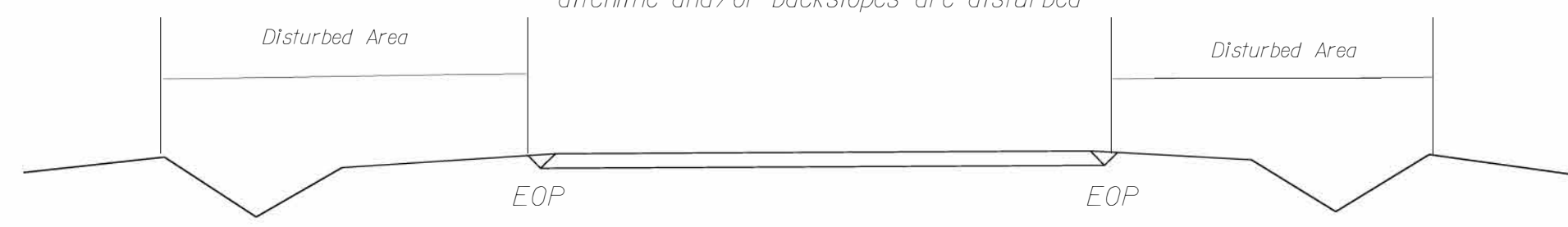

< 5' - 10' Undisturbed buffer from inlet, add wattle

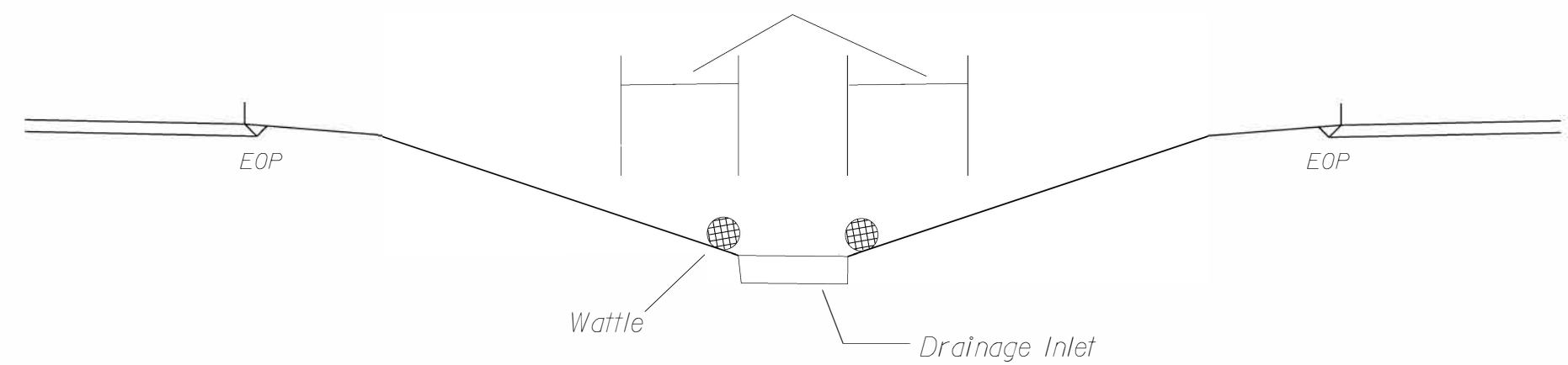

NOT TO SCALE

DIVISION OF HIGHWAYS
STATE OF NORTH CAROLINA

SOIL STABILIZATION TIMEFRAMES

SITE DESCRIPTION	STABILIZATION TIME	TIMEFRAME EXCEPTIONS
PERIMETER DIKES, SWALES, DITCHES AND SLOPES	7 DAYS	NONE
HIGH QUALITY WATER (HQW) ZONES	7 DAYS	NONE
SLOPES STEEPER THAN 3:1	7 DAYS	IF SLOPES ARE 10' OR LESS IN LENGTH AND ARE NOT STEEPER THAN 2:1, 14 DAYS ARE ALLOWED.
SLOPES 3:1 OR FLATTER	14 DAYS	7 DAYS FOR SLOPES GREATER THAN 50' IN LENGTH.
ALL OTHER AREAS WITH SLOPES FLATTER THAN 4:1	14 DAYS	NONE, EXCEPT FOR PERIMETERS AND HQW ZONES.

SIGNING FOR RESURFACING PROJECTS

LEGEND
 ┆ STATIONARY SIGN
 ← DIRECTION OF TRAFFIC FLOW

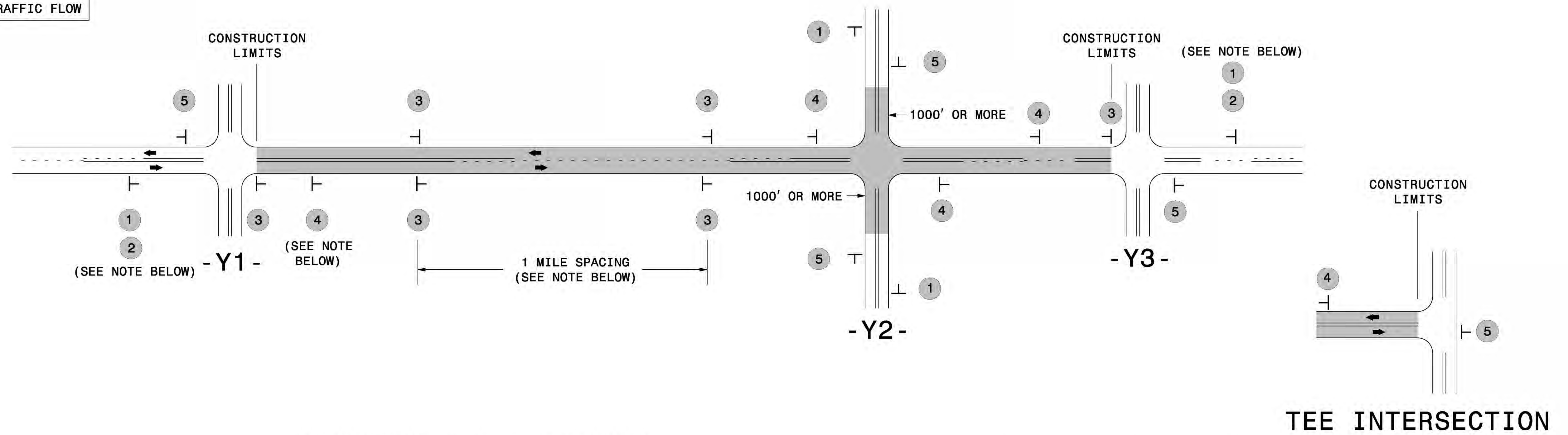

MAINLINE (-L-) SIGNING

-Y- LINE SIGNING

SIGNING NOTES AND PLACEMENT PER DIRECTION	1		PLACE 1000' PRIOR TO BEGINNING OF CONSTRUCTION LIMITS. ONLY USED ON -Y- LINES IF RESURFACING LIMITS EXTEND 1000' ALONG -Y- LINE.	<p>NO REQUIRED STATIONARY SIGNING FOR THE FOLLOWING -Y- LINE CONDITIONS:</p> <ol style="list-style-type: none"> 1) LESS THAN 1000' OF RESURFACING ALONG -Y- LINE 2) SUBDIVISION ROADS 3) DEAD END ROADS <p>WHEN PAVING/CONSTRUCTION ACTIVITIES PROCEED ACROSS AN UNSIGNED -Y- LINE, PORTABLE ADVANCE WARNING SIGNS SHALL BE USED ALONG THE -Y- LINE AS SHOWN BELOW. REMOVE UPON COMPLETION OF WORK.</p> <div style="display: flex; justify-content: space-around;"> <div style="text-align: center;"> PLACED 500' IN ADVANCE OF FLAGGER. </div> <div style="text-align: center;"> PLACED 250' IN ADVANCE OF FLAGGER. </div> </div>
	2		#2 SIGN ONLY USED WHEN CONSTRUCTION LIMITS ARE 2 OR MORE MILES IN LENGTH. ROUND UP TO NEXT WHOLE NUMBER. (NO FRACTIONAL OR DECIMAL NUMBERS)	
	3		- PLACE INITIALLY AT THE CONSTRUCTION LIMITS AND SPACE 1 MILE APART THEREAFTER. - AT TEE INTERSECTIONS INSTALL INITIALLY 1/2 MILE FROM INTERSECTION AND SPACE 1 MILE APART THEREAFTER.	
	4		- THESE ARE FOR -Y- LINES THAT ARE "THROUGH" ROADWAYS. - DEAD END AND SUBDIVISION ROADS ARE NOT "THROUGH" ROADWAYS. - INSTALL 500' +/- FROM EACH -Y- LINE APPROACH AS SHOWN ABOVE. - FOR MULTIPLE -Y- LINES THAT ARE SEPARATED BY 0.25 MILES OR LESS, TREAT AS A SINGLE UNIT AND INSTALL WITHIN 500' OF EACH APPROACH. - A MAXIMUM OF 2 SIGN SETS PER MILE. DO NOT INSTALL WHEN -Y- LINES ARE WITHIN 0.5 MILES FROM "END ROAD WORK" SIGN. - FOR TEE INTERSECTIONS, INSTALL WITHIN 500' +/- OF THE INTERSECTION ALONG -L- LINE.	
	5		PLACE 500' FOLLOWING THE END OF CONSTRUCTION LIMITS OR AS SHOWN WHEN WORK ENDS AT A 3-WAY TEE INTERSECTION.	

THE ABOVE SIGNS ARE ALL THAT ARE REQUIRED FOR A CONTRACTOR TO BEGIN A RESURFACING CONTRACT. ANY ADDITIONAL SIGNS REQUESTED BY NCDOT DIVISIONS SHALL BE INSTALLED WITHIN 7 BUSINESS DAYS OF THE START OF CONTRACT WORK.

MAPS LESS THAN 2 MILES

FOR RESURFACING MAPS WITH CONSTRUCTION LIMITS LESS THAN 2 MILES IN LENGTH, NO STATIONARY SIGNS ARE REQUIRED. USE PORTABLE "ROAD UNDER CONSTRUCTION" OR "ROAD WORK AHEAD" SIGNS IN LIEU OF STATIONARY ADVANCE WARNINGS SIGNS.

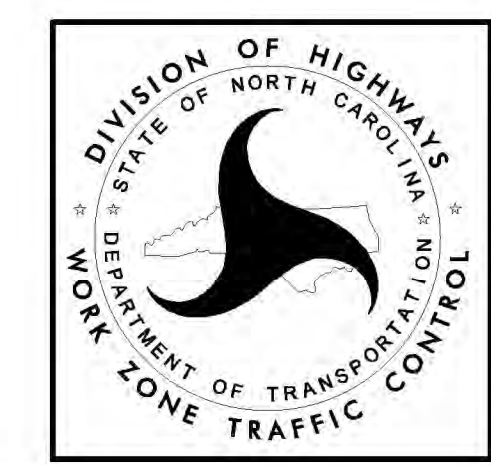

ADVANCE WARNING SIGNS FOR RURAL AND SUBURBAN 2-LANE ROADWAY RESURFACING

5/15/2017 5:11:10 PM \\NCDOT\GIS\Resurfacing\2L2W & AST Resurfacing Details\Resurfacing_AdvWarn_2Ln.dgn User:keads